



This module combines a given number of diodes on a single printed board. The diodes are connected to terminals.

Typical applications:

Lamp test circuits - the signals are connected without reaction. The diodes are connected in pairs and can be wired freely to the anode.

Explosion protection

Marking ATEX	II 2G Ex db e IIC Gb II M2 Ex db e I Mb
Certification	PTB 97 ATEX 1068 U
Marking IECEx	Ex d e IIC Gb Ex d e I Mb
Certification	IECEx PTB 11.0083U
Marking CSA	Class I, Zone 1, IIC A/Ex d e IIC Gb
Certification	CSA 2011-2484303U
Other approvals and certificates, see www.bartec.de	

Technical data

Enclosure material	High quality thermoplastic
Protection class	Module IP 66 EN/IEC 60529 Terminals IP 20 EN/IEC 60529
Terminals	2.5 mm ² , fine stranded
Mounting rail	TH 35 x 7.5 (15) EN/IEC 60715
Terminal designation	written marking labels
Ambient temperature	-25 °C to +60 °C at T4
Storage temperature	-40 °C to +70 °C
Weight	0.400 kg

1

Dimensions/mounting positions

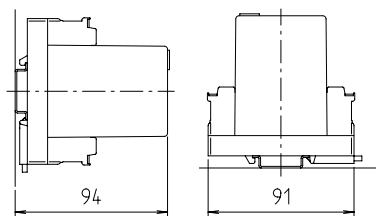

Module width: 75 mm

Electrical data

Input voltage	max. DC 300 V
Reverse voltage	1000 V
Diode current	0.3 A max per lamp, Type 1N4007

Ordering information

Lamp test circuit **07-7311-97GW/E3K0**

Technical data subject to change without notice.

Wiring diagram/terminal assignment

